

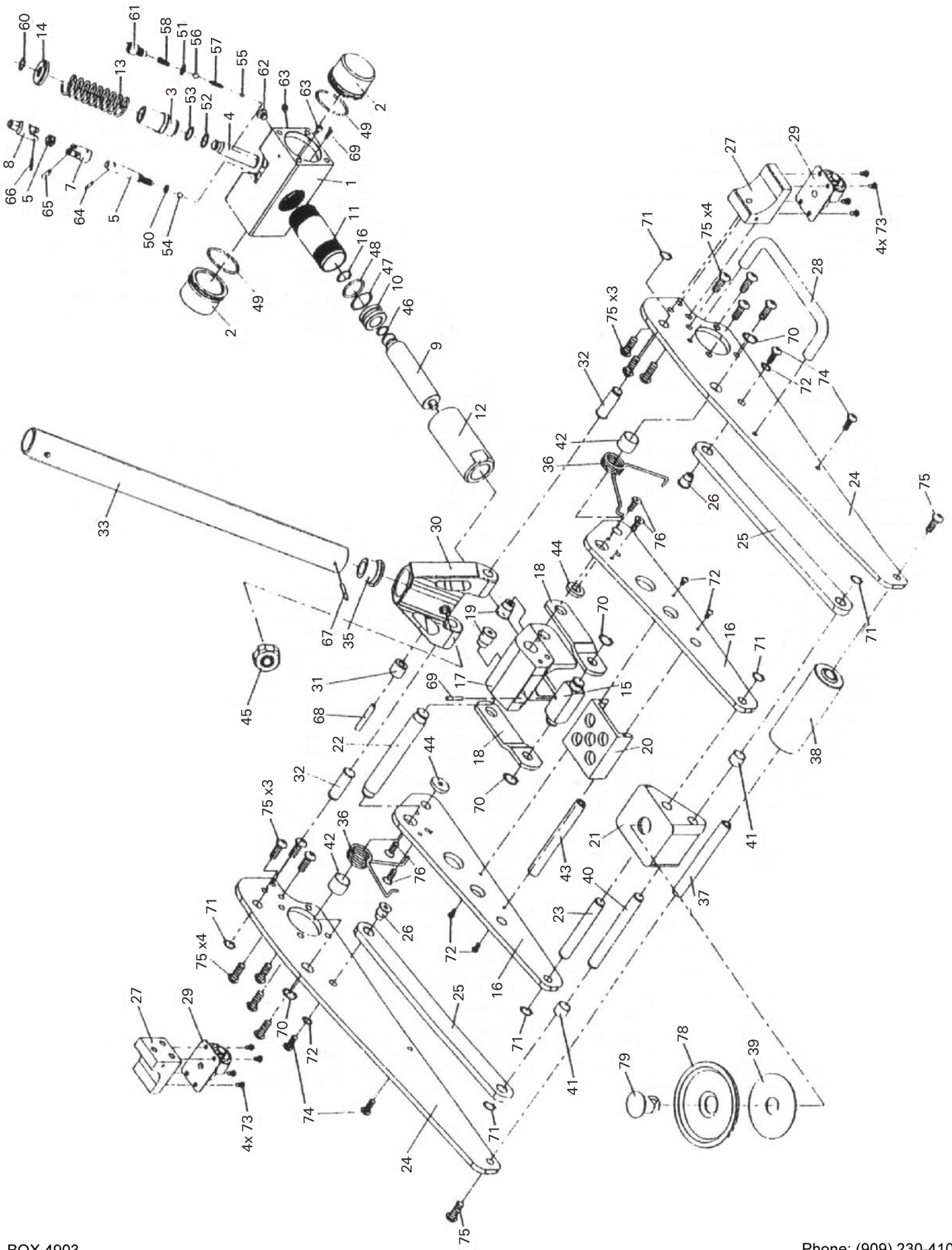

ZSJ-10A Parts Breakdown

Toll Free: 1-800-579-8088 Web: www.zinko.com

REV 041916 page 1 of 2





ZSJ-10A Parts Breakdown

Toll Free: 1-800-579-8088 Web: www.zinko.com

REV 041916 page 2 of 2

#	PART #	DESCRIPTION
01	9040010A-01	Aluminum Base
02	9040015A-02	Oil Cover
03	9040015A-03	Piston Cylinder
04	9040015A-04	Piston
RV	9040015A-RV	Release Valve Assy'
06	RV	get 9040010A-RV
07	RV	*** (including 05-08,64,65,66)
08	RV	
09	9040010A-09	Cylinder
10	9040015A-29	Bush
11	9040015A-24	Hydraulic Cylinder
12	9040010A-12	Aluminum Bar
13	9040015A-10	Piston Extension Spring
14	9040015A-09	Piston Cover
15	9040015A-59	Cylinder Axis
16	9040010A-16	Raise Arms
16L	9040010A-16L	Raise Arm, Left
16R	9040010A-16R	Raise Arm, Right
17	9040010A-17	Raise Arm's Base
18	9040015A-58	Pull Rod
19	9040015A-41	Pull Rod Axis
20	9040010A-20	Support Plank
21	9040015A-64	Saddle Base
22	9040015A-42	Raise Arm's Axis
23	9040010A-23	Holder Axis
24	9040010A-24	Left Frame
25	9040015A-55	Link Rod
26	9040015A-54	Link Rod Axis
27	9040010A-27	Rear Wheel Saddle
28	9040015A-50	Handle Bar
29	9040010A-29	Rear Wheel Assembly
30	9040015A-37	Handle Base
31	9040015A-38	Piston Roll Wheel
32	9040015A-40	Handle Base Axis
33	9040010A-33	Handle, One-piece
35	9040015A-35	Handle Gear Base
36L	9040015A-44	Turn Spring, Left
36R	9040015A-43	Turn Spring, Right
37	9040015A-61	Front Wheel Axis
38	9040015A-60	Front Caster Wheel
39	9040015A-65	Nylon Washer
40	9040015A-23	Saddle Base Axis (Long)
41	9040010A-41	Link Rod Washer

#	PART #	DESCRIPTION
42	9040010A-42	Raise Arm's Bush
43	9040010A-43	Patch Strong Axis
44	9040010A-44	Patch Strong Ring
45	9040015A-36	Handle Base Screw
46	9040015A-30	* O-Ring P12
47	RP	* Back-Seal P30
48	RP	* O-Ring P30
49	RP	* O-Ring G55
50	RP	* O-Ring P9
51	9040015A-15	Brass Wash
52	RP	* O-Ring P22
53	RP	* Back-Seal P22
54	9040015A-16	Steel Ball 8 mm
55	9040015A-18	Steel Ball 5.5 mm
56	9040010A-56	Steel Ball 8 mm
57	9040015A-17	L-Spring
58	9040015A-14	H-Spring
59	9040015A-21	Oil Net
60	9040010A-60	C-Ring S15
61	9040015A-13	Screw (H)
62	9040015A-19	Oil Screw
63	9040015A-20	Lock Screw
64	RV	Spring Pin 4 mm
65	RV	Pin 6 mm
66	RV	Spring Pin 3
67	9040015A-34	Spring Pin 5 (Long)
68	9040015A-39	Spring Pin 8
69	9040010A-69	Spring Pin 5 (Short)
70	9040015A-08	C-Ring S20
71	9040015A-25	C-Ring S16
72	9040015A-52	Washer 8*12
73	9040010A-73	Screw M6*10
74	9040010A-74	Screw M8*20
75	9040015A-45	Screw M10*25
76	9040010A-76	Screw M8*20 (A)
77	9040010A-77	Screw M6*16
78	9040010A-78	Saddle
79	9040015A-67	Holder Axis
102	9040010A-102	Power unit
RP	9040010A-RP	Repair Parts Kit
RV	9040010A-RV	Release Valve Ass'y
DTS	9040015A-DTS	Dirt Track Stabilizer